



Aldington Close, Dagenham, RM8 1YQ

£2,250 Per Calendar Month





£2,250 Per Calendar Month

# Aldington Close

Dagenham, RM8 1YQ

- 3 Bedroom House
- Kitchen/Diner
- Chadwell Heath Station (Elizabeth Line)
- Large Reception
- First Floor Bathroom
- Local Shops and Amenities nearby

\*\*\*AVAILABLE IMMEDIATELY - OFF STREET PARKING - PRIVATE GARDEN\*\*\*

Sandra Davidson are proud to present this lovely three bedroom house situated in this popular turning off Chadwell Heath High Road, close to all shops, including Tesco superstore, within walking distance to Chadwell Heath Station (Elizabeth Line). The property features a large lounge diner, separate fitted kitchen, three bedrooms, first floor bathroom, private rear garden and off street parking.



OPEN PLAN LOUNGE	13'6" x 13'7" (4.14m x 4.16m)
DINING SECTION	11'5" x 6'8" (3.48m x 2.05m)
KITCHEN	11'5" x 6'5" (3.48m x 1.98m)
LANDING WITH STAIRS TO GROUND FLOOR	
BEDROOM ONE	11'8" x 8'2" (3.58m x 2.49m)
BEDROOM TWO	11'5" > 8'6" x 7'5" (3.5m > 2.61m x 2.28m)
BEDROOM THREE	8'8" x 8'8" (2.66m x 2.66m)
BATHROOM	
GARDEN	34'5" (10.5)

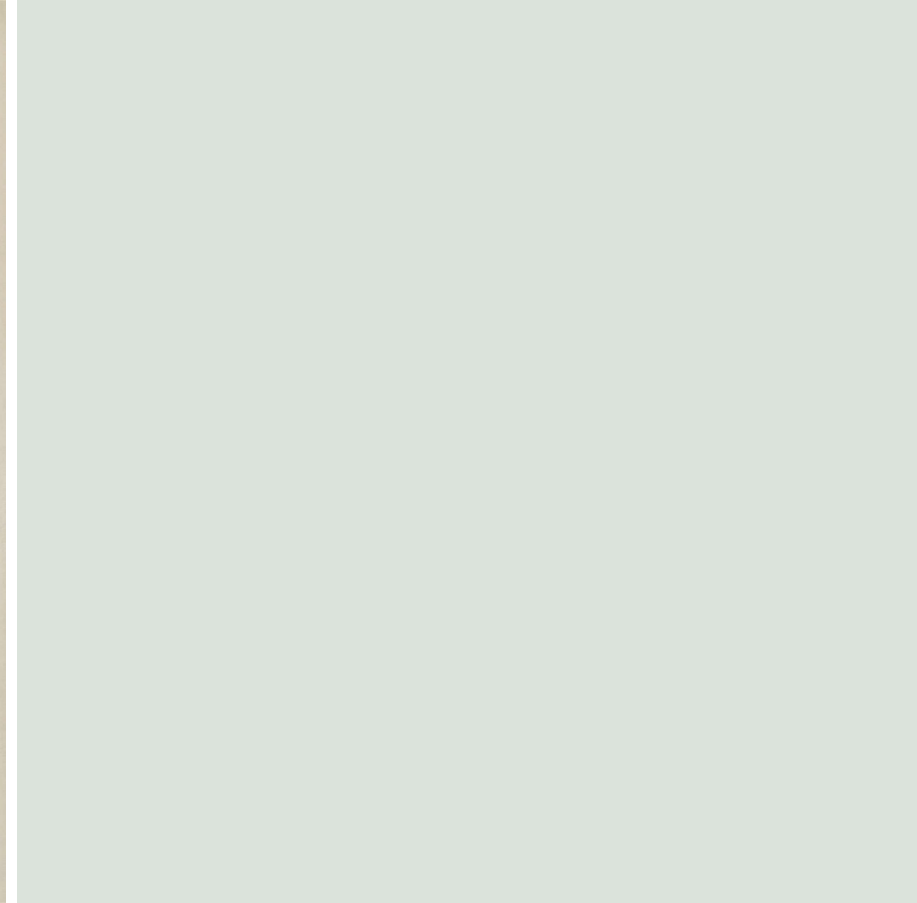

Directions





## Floor Plans

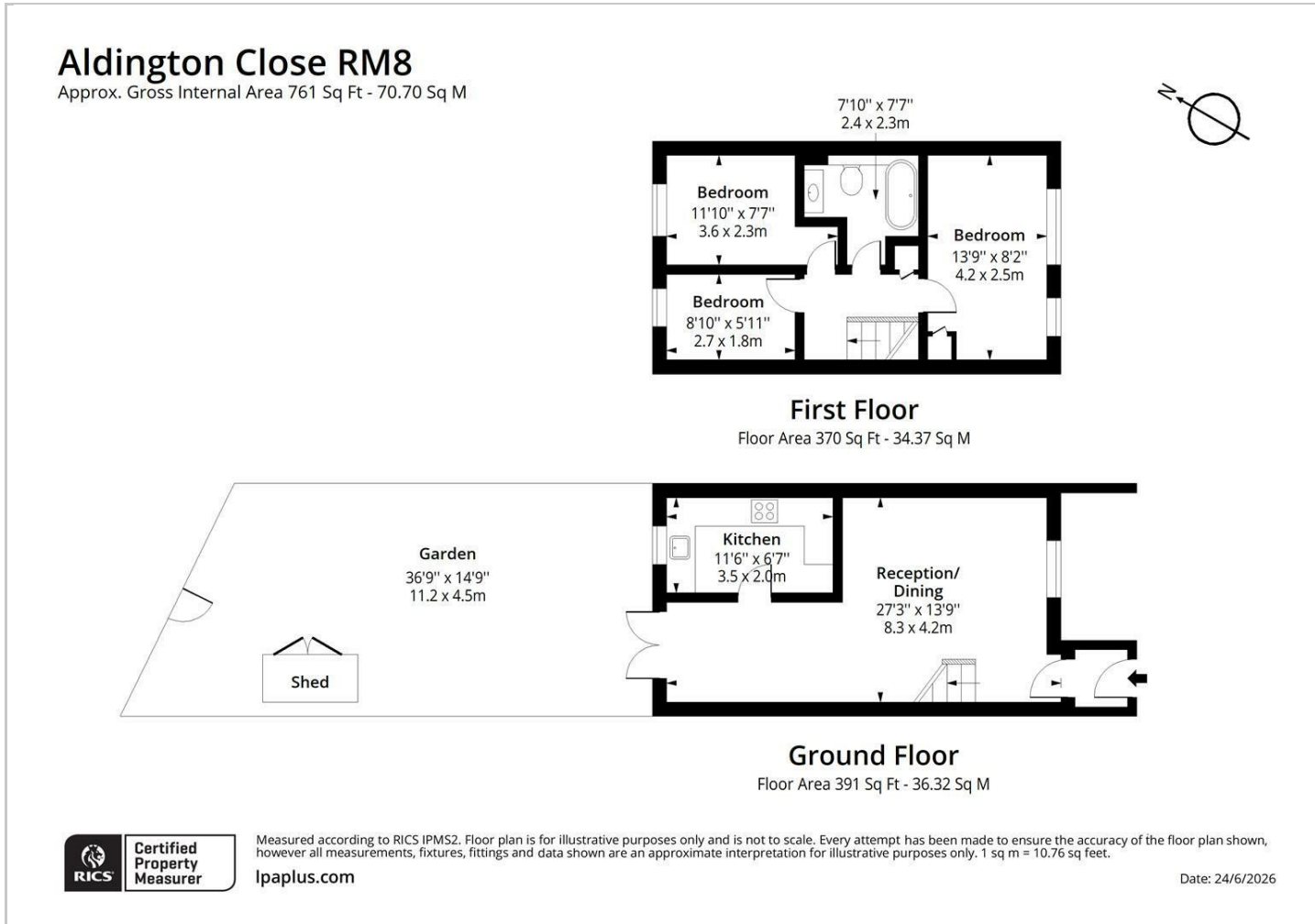

## Viewing

Please contact our Redbridge Lettings Office on 020 8551 0211 if you wish to arrange a viewing appointment for this property or require further information.

The particulars are set out as a general outline only for the guidance of intended purchasers or lessees, and do not constitute, any part of a contract. Nothing in these particulars shall be deemed to be a statement that the property is in good structural condition or otherwise nor that any of the services, appliances, equipment or facilities are in good working order. Purchasers should satisfy themselves of this prior to purchasing.

10 Roding Lane South, Essex, IG4 5NX  
Tel: 020 8551 0211 Email: redbridge@sandradavidson.com <https://www.sandradavidson.com>

## Location Map

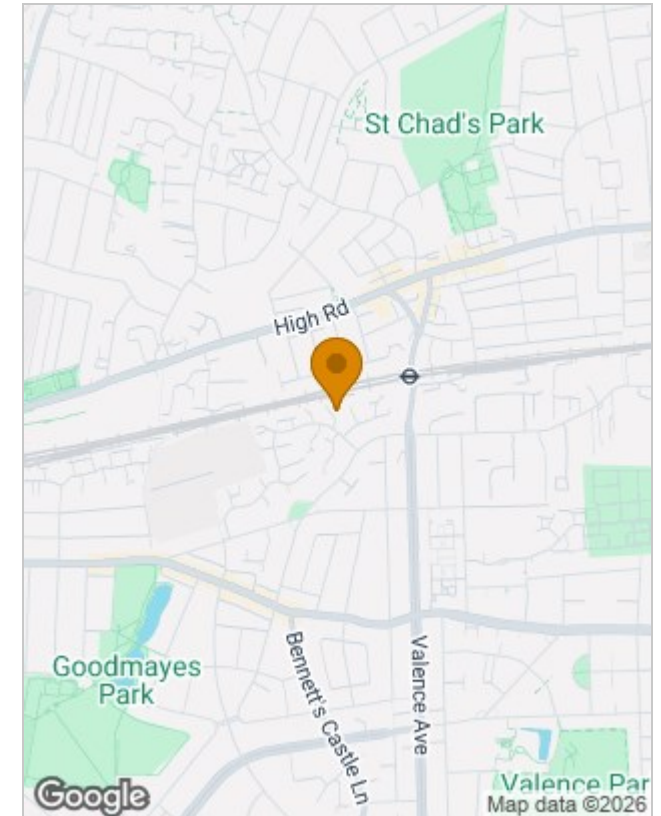

## Energy Performance Graph

